

PA-10

Supply Voltage (Vs): 7-30 Vdc or 3-8 Vdc (MICROPOWER)
 Supply Current: ≤ 10 mA
 Pulse Out (Vo): 0-10 V or 0-5 V (MICROPOWER)
 Frequency Range: Near 0 to 5 kHz, depending on target mass and Air Gap
 Air Gap: 0.16" Max depending on target mass
 Temp. Ranges: **2TE**; -40° to 220° F (-40° to 120° C)
3TE; -40° to 290° F (-40° to 145° C)

4016

FTC 4-20mA, 10-50mA,
 FTV 0-5 V, 0-10 V
 FOR Y3 EXPL. PR. ENCL.

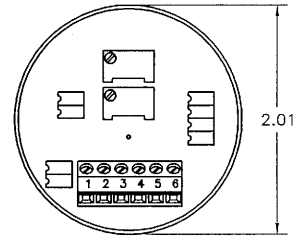

4013

PULSE AMPLIFIER
 FOR Y1 EXPL. PR.
 ENCL.

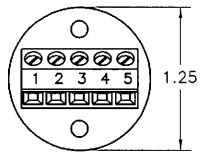

4014

IN-LINE PULSE AMPLIFIER
 WITH MS CONNECTOR

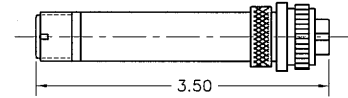

4014M

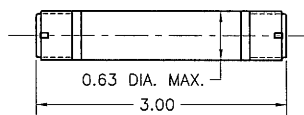

4014H

ULTRA COMPACT

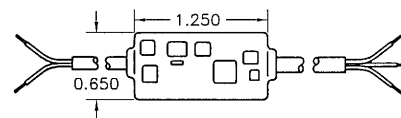

SPEED/FLOW SWITCH, TEMP. TRANSMITTER, POWER SUPPLY

4051

SPEED/FLOW SWITCH, SS1
 MAG TYPE, OPEN COLLECTOR
 OUTPUT
 FOR ELBY EXPL. PR. ENCL.

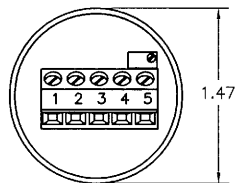

4032

2-WIRE TEMPERATURE TRANSMITTER
 FOR USE w/ RTDs or
 THERMOCOUPLES
 FOR Y-3 EXPL. PR. ENCL.

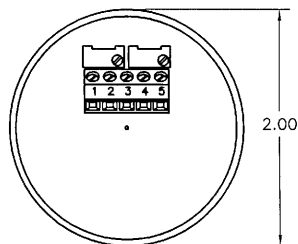

4100

UNIVERSAL POWER SUPPLY
 FOR SIGNAL CONDITIONERS
 IN NEMA 4 ENCLOSURE

Supply Voltage (Vs): 120 VAC $\pm 10\%$, 25 mA
 Voltage Out (Vo): 5V, 12V or 24V
 Connections: AC primary DC output

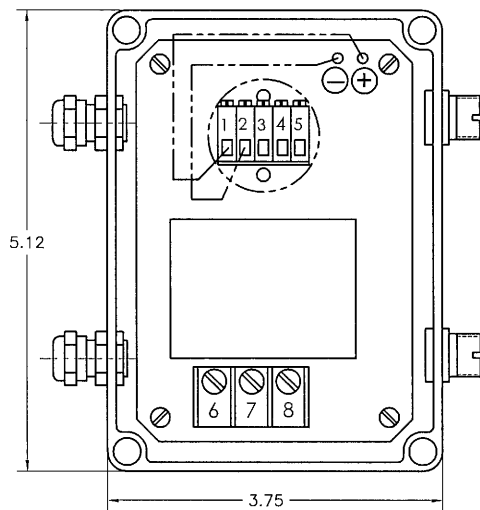

Detailed spec-sheets are available for each sensor listed, please contact Spectec for more information.